

VAG TERRA® M1 Tapping Bridge

for cast iron, steel and cement-bound pipes



Water

PN 16
DN 80...400



Product features

- In accordance with DIN 3543 part 2
- For drilling from above under full operating pressure with tapping machine
- With integrated main shut-off valve
- With integrated easy-to-operate auxiliary ball valve (PTFE seal)
- Outlet thread for all nominal diameters G 1½"
- Maximum drilling diameter 38 mm
- Uniform connection piece for all nominal pipe diameters
- Final inspection test to EN 12266 (DIN 3230 Part 4)

Materials

- Tapping bridge upper part made of brass, nickel plated
- Valve fittings made of brass, stem made of stainless steel 1.4021
- Components of the auxiliary ball valve made of rustproof materials
- Clamping piece made of stainless steel (for AZ pipes 90 mm), rubber on one side or completely rubber coated clamping piece; screw pieces and nuts made of stainless steel
- Saddle seal made of NBR

Corrosion protection

- Connection piece lower part inside and outside epoxy coated

Field of application

- Max. operating temperature for neutral liquids: 50°C

Versions

- Clamping piece (with saddle seal) are allocated to the respective pipe diameters and materials (see table)
- PE welding points da 32, 40 and 50 with integrated seal (loose accessory)
- With completely rubber coated clamping piece ¹⁾

On request

- PE welding points da 32, 40, 50 and 63

Accessories

- Operating key E (square 12 mm)
- Installation fittings
- Street box, cast iron
- Street box, plastic
- Street box, plastic, adjustable
- Supporting plate plastic
- PE welding points
 - da 32
 - da 40
 - da 50

connection piece

- DN: all nominal diameters

The DVGW work sheet W333 "Tapping valves and tapping process in water supply systems" must be observed during the assembly of the valve and tapping process.

Field of Use

Final Inspection Test in acc. with EN 12266

DN	PN	Max. operating pressure	Max. operating temperature for neutral liquids	Test pressure in bar with water	
				in body	in seat
mm	bar	bar	°C		
80...400	16	16	50	24	17,6

Suitable for cast iron, fibre-cement and PE-sheathed cast iron pipes as well as for steel pipes and PE-sheathed steel pipes

We reserve the right to make technical changes and use similar or higher-quality materials. Drawings are non-binding



Dimensions / weights

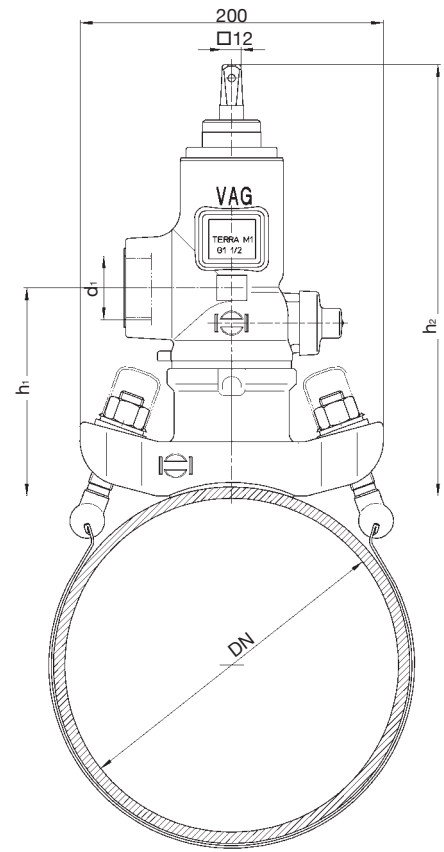

Dimensions in mm		
Feed line	DN	80...400
Outlet height	h_1	137
Total height	h_2 closed	284
	h_2 open	304
Outlet thread	d_1	G 1 1/2"
Turns/ stroke		9
Weight of connection piece kg \approx		6.65
Space req.		0.01

clamping piece

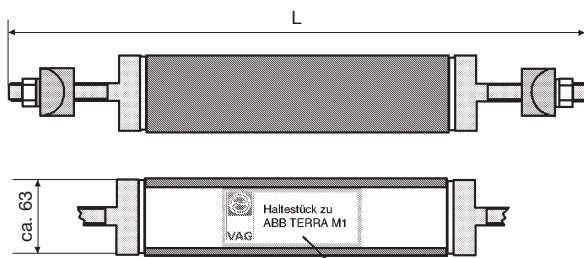

²⁾ special height 90 mm

identification label, self-adhering

saddle seal

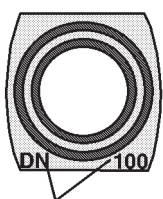

identification is vulcanised on

Dimensions in mm								
DN	Outside diameter of pipe range	L	Pipe material					
			GGG-	GGG-PE	GGG-ZM	St	St-PE	AZ ²⁾
80 ¹⁾	88 - 100	380	•					
80	97 - 110							•
80 ¹⁾	98 - 110	395		•	•			
100 ¹⁾	113 - 123	445	•	•		•	•	
100	119 - 132							•
100 ¹⁾	123 - 133	470			•			
125 ¹⁾	137 - 150	515	•	•		•	•	
125 ¹⁾	145 - 157	525		•	•			
125	149 - 162							•
150 ¹⁾	166 - 178	590	•	•		•	•	
150 ¹⁾	170 - 182	600		•	•			
150	178 - 191							•
200 ¹⁾	216 - 228	735	•	•		•	•	
200 ¹⁾	223 - 235	750		•	•			
200	232 - 245							•
250	270 - 280	885	•	•		•	•	
250	275 - 287	900		•	•			
250	286 - 298							•
300	319 - 331	1035	•	•		•	•	
300	327 - 337	1050		•	•			
300	341 - 353							•
350	352 - 364					•	•	
350	374 - 384	1190	•	•				
350	383 - 393	1220			•			
400	402 - 412	1280				•		
400	406 - 416	1285					•	
400	424 - 434		•	•				
400	434 - 444				•			